



Low Voltage
IEC | Three-Phase
Induction Motors
IE2 High Efficiency

Precision in Motion

About Felco Motors

FELCO motors is a global supplier specializing in Industrial Electric Motors, Fractional horsepower motors, drives, and HVAC equipment.

Our strength lies in a dynamic team of seasoned senior engineers, ambitious young professionals, and a dedicated sales and marketing force. Together, we combine deep technical expertise with a clear understanding of our customers' needs to deliver complete solutions and ensure total customer satisfaction.

At **FELCO**, we strive to be the preferred brand in carefully selected niches, segments, and applications. We are committed to building strong

partnerships founded on trust and collaboration - delivering unique value and driving mutual success.

Our products are designed and manufactured to meet the highest international standards, ensuring reliability, efficiency, and long-term performance. Whether it's a standard motor or a customized solution, we work closely with our partners to deliver exactly what their application demands.

We believe in continuous improvement, investing in innovation, training, and product development to stay ahead in a fast-changing market. At Felco, we don't just sell motors we provide power, precision, and peace of mind.

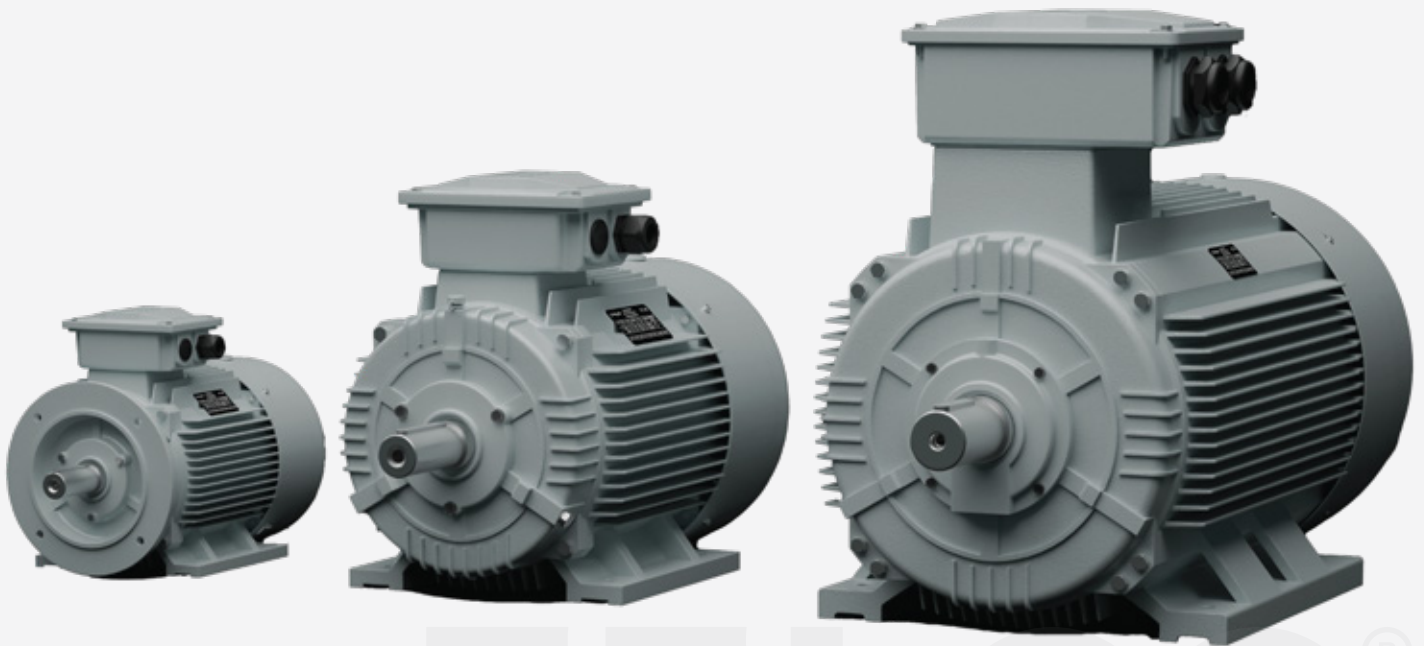

FELCO®

Felco IE2 Electric Motors

Certifications & Quality Standards

At **FELCO**, quality is not just a promise-it's built into every product we deliver. Our manufacturing, design, and testing processes are aligned with globally recognized standards, ensuring safety, efficiency, and long-term performance.



ISO 9001:2015

Quality Management System

This standard helps companies make sure their products and services are high quality and meet customer needs. It focuses on improving processes and customer satisfaction



ISO 14001:2015

Environmental Management System

This standard helps companies reduce their impact on the environment. It supports better use of resources, less waste, and following environmental laws.



ISO 45001:2018

Occupational Health & Safety Management System

This standard helps companies create a safe and healthy workplace. It focuses on reducing risks, preventing accidents, and protecting employees.



CE Marking

Complies with European safety, health, and environmental protection regulations.



UL Listed

Certified for North American electrical and fire safety requirements

Warranty :

All **FELCO** motors are backed by a **24-months warranty** from the date of invoice, covering manufacturing defects and workmanship under normal operating conditions

Felco IE2

Electric Motors

FELCO IE2 (High Efficiency) electric motors are designed to provide reliable, standardized performance across a broad range of general-purpose industrial applications. Built to meet the requirements of IEC 60034-30-1 and in compliance with EC Directive 2009/125 (Eco-design), **FELCO** IE2 motors offer an optimal balance of performance and cost-efficiency, making them ideal for light to medium-duty installations where energy savings are important but not critical.

Trusted by OEMs and end-users in sectors such as manufacturing, agriculture, building services, and utilities, **FELCO** IE2 motors are engineered for consistent operation and easy integration into global systems. They are available in both aluminum and cast iron construction, supporting a wide variety of mounting options and voltage configurations.

Technical Specifications

Motor Series

- FMA2 (Aluminum housing): Frame sizes 56 to 160 (size 180 available on request)
- FMC2 (Cast iron housing): Frame sizes 180 to 400 (custom sizes on request)

Construction Details

- Rotor: Precision die-cast aluminum rotor with optimized lamination profile for efficient flux distribution
- Shaft: C45 high-grade steel, precision-ground for superior mechanical integrity

Bearing System

- Frame size ≤ 132 : SKF, NSK, or FAG ZZ shielded bearings
- Frame size ≥ 160 : SKF, NSK, or FAG wide-range bearings with C3 clearance
- Standard bearings: Closed type (≤ 160); open type (≥ 180)

Stator Winding & Insulation

- Copper windings with double-coated magnet wire and layered inter-phase insulation
- Insulation Class: Standard Class F with temperature rise limited to Class B
- Optional: Class H insulation available on request

Compliance & Testing

- Manufactured and tested as per IEC 60034, IEC 60072, and EN 50347
- Performance testing in accordance with IEC 60034-2-1
- Rotor dynamically balanced with half key (IEC 60034-14, Grade A)
- Noise level compliant with IEC 60034-9
- Cooling method: Standard IC411; optional IC416 available

Felco IE2 Electric Motors

Electrical Characteristics

Standard Voltage & Frequency

- Up to 3 kW: Δ/Y 230/400 V, 50 Hz (factory setting: 400 V)
- 4 kW and above: Δ/Y 400/690 V, 50 Hz (factory setting: 400 V)
- Other voltages and frequencies available upon request

Protection & Optional Features

Standard Protection

- IP55 ingress protection with drain hole preparation
- Optional IP56, IP65, IP66 enclosures for challenging environments
- Optional PTC thermistors for basic thermal protection

Optional Enhancements

- Bimetallic thermal cutouts
- Anti-condensation heaters
- PT100 sensors for windings or bearings (on request)

Design & Accessories

- Terminal box pre-fitted with cable glands
- Lifting eyebolts on frame sizes ≥ 100 for safe handling
- Painted in RAL 7038 industrial-grade low-gloss finish
- Available with multiple mounting types: B3, B5, B14, B35, V1, etc.

Application Information

FELCO IE2 motors are designed for long-lasting performance in less energy-intensive environments where simplicity, durability, and compliance matter. These motors are suitable for:

Fans & Blowers

- Ventilation units
- Low-duty HVAC systems

Pumps

- Irrigation, transfer pumps
- Basic water supply systems

Compressors

- Small air compressors
- Light-duty industrial equipment

Machinery & Conveyors

- Belt conveyors
- Packaging and assembly lines

General Industrial Equipment

- Mixers, agitators
- Agricultural machinery

Efficiency curves for IE2, IE3 and IE4 4-pole 50Hz electric motors

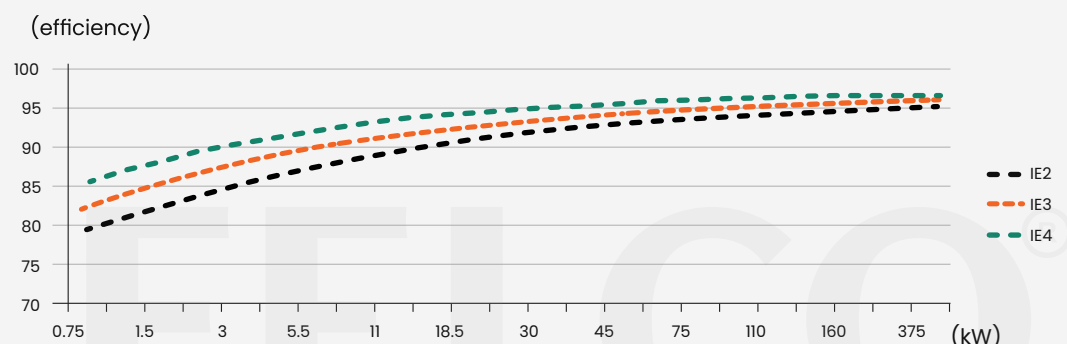

IE2 / 2 Pole

Motor Type	Power	Current(A) at 400V		Speed	Efficiency(η)			PF	Rated Torque			Locked Current	Weight
	(kw)	amp	Conn.	(rpm)	100%	75%	50%	($\cos\phi$)	(Nm)	Ts/Tn	Tmax/Tn	Is/In	(Kg)

Aluminium Motors

FMA2-80A-2	0.75	1.69	Y	2875	77.4	77.2	74.7	0.83	2.49	2.50	3.00	5.30	8.2
FMA2-80B-2	1.1	2.40	Y	2875	79.6	79.7	78.9	0.83	3.65	3.20	3.80	7.00	9.2
FMA2-90S-2	1.5	3.17	Y	2890	81.3	81.4	80.7	0.84	4.96	2.70	3.50	7.10	13.1
FMA2-90L-2	2.2	4.49	Y	2890	83.2	82.9	82.2	0.85	7.27	2.40	3.00	6.90	16
FMA2-100L-2	3	5.88	Y	2891	84.6	84.5	82.8	0.87	9.91	3.20	4.00	8.00	22.3
FMA2-112M-2	4	7.65	Δ	2914	85.8	86.1	85.4	0.88	13.1	2.5	3.0	7.5	30.4
FMA2-132SA-2	5.5	10.4	Δ	2937	87.0	86.7	84.8	0.88	17.9	2.7	3.5	7.5	46
FMA2-132SB-2	7.5	13.8	Δ	2940	88.1	88.4	87.8	0.89	24.4	2.4	3.3	7.5	51.2
FMA2-160MA-2	9.2	20.0	Δ	2930	89.4	89.1	87.7	0.89	35.9	2.2	2.9	7.6	90
FMA2-160MB-2	11	26.9	Δ	2930	90.3	90.5	89.7	0.89	48.9	2.3	3.0	7.6	100
FMA2-160L-2	11	33.0	Δ	2937	90.9	91.0	90.0	0.89	60.2	2.3	3.1	7.4	111

Cast Iron Motors

FMC2-160L-2	18.5	33.0	Δ	2937	90.9	90.6	89.1	0.89	60.15	2.30	3.10	7.40	135.00
FMC2-180M-2	22	39.1	Δ	2940	91.3	91.0	89.4	0.89	71.46	2.80	3.20	7.80	183.00
FMC2-200LA-2	30	52.9	Δ	2950	92.0	91.8	90.2	0.89	97.12	2.60	3.00	7.80	227.00
FMC2-200LB-2	37	64.9	Δ	2950	92.5	92.4	90.7	0.89	119.78	2.60	3.00	7.70	246.00
FMC2-225M-2	45	78.6	Δ	2960	92.9	92.8	91.3	0.89	145.19	2.40	2.60	7.50	297.00
FMC2-250M-2	55	95.7	Δ	2965	93.2	93.3	91.5	0.89	177.15	2.30	2.80	7.10	379.00
FMC2-280S-2	75	129.7	Δ	2970	93.8	93.8	91.9	0.89	241.16	2.50	2.80	7.40	519.00
FMC2-280M-2	90	155.1	Δ	2970	94.1	94.0	92.2	0.89	289.39	2.80	2.80	7.60	580.00
FMC2-315S-2	110	187.1	Δ	2975	94.3	94.2	92.4	0.9	353.11	2.40	2.80	6.90	948.00
FMC2-315M-2	132	223.8	Δ	2975	94.6	94.6	92.7	0.9	423.73	2.60	2.90	7.10	1009.00
FMC2-315LA-2	160	267.7	Δ	2975	94.8	94.9	93.1	0.91	513.61	2.50	2.90	7.10	1111.00
FMC2-315LB-2	200	333.9	Δ	2975	95.0	95.1	93.3	0.91	642.02	2.50	2.80	6.90	1142.00
FMC2-355M-2	255	417.4	Δ	2980	95.0	95.0	93.4	0.91	801.17	2.50	2.80	7.00	1908.00
FMC2-355L-2	315	525.9	Δ	2980	95.0	95.1	93.4	0.91	1009.48	2.50	2.90	7.00	2346.00

IE2 / 4 Pole

Motor Type	Power	Current(A) at 400V		Speed	Efficiency(η)			PF	Rated Torque			Locked Current	Weight
	(kw)	amp	Conn.	(rpm)	100%	75%	50%	($\cos\phi$)	(Nm)	Ts/Tn	Tmax/Tn	Is/In	(Kg)

Aluminium Motors

FMA2-80B-4	0.75	1.81	Y	1400	79.6	79.3	78.4	0.75	5.12	2.40	2.90	5.00	11
FMA2-90S-4	1.1	2.60	Y	1400	81.4	81.1	77.6	0.75	7.3	3.0	3.5	6.0	13.1
FMA2-90L-4	1.5	3.49	Y	1445	82.8	82.5	77.5	0.75	9.91	3.20	3.80	6.80	16.3
FMA2-100LA-4	2.2	4.65	Y	1440	84.3	84.4	83.7	0.81	14.6	3.0	3.5	7.0	23.5
FMA2-100LB-4	3	6.18	Y	1440	85.5	85.3	83.9	0.82	19.9	2.6	3.3	7.0	26
FMA2-112M-4	4	8.13	Y	1445	86.6	86.9	86.9	0.82	26.4	3.5	4.0	7.5	33.1
FMA2-132S-4	5.5	11.0	Δ	1455	87.7	87.4	86.9	0.82	36.1	2.2	2.8	6.4	46.1
FMA2-132M-4	7.5	14.7	Δ	1455	88.7	88.5	88.3	0.83	49.2	2.4	3.0	7.0	54.3
FMA2-160M-4	11	20.8	Δ	1460	89.8	90.1	89.1	0.85	71.9	2.5	2.9	6.9	108
FMA2-160L-4	15	27.8	Δ	1460	90.6	90.8	89.9	0.86	98.1	2.5	3.0	7.5	114

Cast Iron Motors

FMC2-180M-4	18.5	34.0	Δ	1465	91.2	91.1	90.5	0.86	120.20	2.60	3.10	7.80	172
FMC2-180L-4	22	40.3	Δ	1465	91.6	91.7	90.9	0.86	142.9	2.6	3.1	7.5	180
FMC2-200L-4	30	54.6	Δ	1475	92.3	92.2	91.3	0.86	194.90	2.40	2.90	7.10	247
FMC2-225S-4	37	67.0	Δ	1480	92.7	92.8	91.7	0.86	238.8	2.5	2.7	7.5	297
FMC2-225M-4	45	81.1	Δ	1480	93.1	93.2	92.1	0.86	290.4	2.5	2.8	7.6	322
FMC2-250M-4	55	98.7	Δ	1485	93.5	93.4	92.4	0.86	354.9	2.6	2.7	7.3	413
FMC2-280S-4	75	130.9	Δ	1480	94.0	94.1	92.8	0.88	484.0	2.7	2.7	7.6	558
FMC2-280M-4	90	156.9	Δ	1485	94.2	94.2	93.1	0.88	580.7	2.7	2.7	7.5	632
FMC2-315S-4	110	190.9	Δ	1480	94.5	94.4	93.3	0.88	707.4	2.7	2.9	7.1	826
FMC2-315M-4	132	228.6	Δ	1480	94.7	94.8	93.7	0.88	888.9	2.7	2.9	7.3	1037
FMC2-315LA-4	160	273.4	Δ	1480	94.9	94.8	93.8	0.89	1029.0	3.00	3.00	7.40	1107
FMC2-315LB-4	200	341.1	Δ	1480	95.1	95.1	94.0	0.89	1286.0	3.0	3.0	7.6	1156
FMC2-355M-4	250	421.6	Δ	1490	95.1	95.1	94.0	0.9	1602.0	2.80	2.90	7.50	1734
FMC2-355L-4	315	531.2	Δ	1490	95.1	95.1	94.0	0.9	2019.0	2.6	2.8	7.4	1940

IE2 / 6 Pole

Motor Type	Power	Current(A) at 400V		Speed	Efficiency(η)			PF	Rated Torque			Locked Current	Weight
	(kw)	amp	Conn.	(rpm)	100%	75%	50%	($\cos\phi$)	(Nm)	Ts/Tn	Tmax/Tn	Is/In	(Kg)

Aluminium Motors

FMA2-90S-6	0.75	1.98	Y	934	79.5	76.1	75.1	0.72	7.67	2.20	2.40	4.50	13
FMA2-90L-6	1.1	2.78	Y	945	78.1	77.9	77.8	0.73	11.1	2.4	2.6	4.5	16.5
FMA2-100L-6	1.5	3.67	Y	945	79.8	80.1	78.5	0.74	15.2	1.8	2.2	4.2	23.2
FMA2-112M-6	2.2	5.25	Y	960	81.8	81.9	81.5	0.74	21.9	2.3	2.8	4.5	32
FMA2-132S-6	3	7.02	Y	964	83.3	83.6	82.3	0.74	29.7	1.8	2.4	4.5	42
FMA2-132M1-6	4	9.22	Δ	965	84.6	84.5	82.4	0.74	39.6	2.3	2.7	5.0	51
FMA2-132M2-6	5.5	12.3	Δ	965	86.0	85.9	84.7	0.75	54.4	1.9	2.8	5.5	61
FMA2-160M-6	7.5	15.9	Δ	970	87.2	87	84.9	0.78	73.8	2.0	3.0	6.5	120
FMA2-160L-6	11	22.7	Δ	970	88.7	88.4	86.1	0.79	108.3	2.4	3.3	7.5	133

Cast Iron Motors

FMC2-180L-6	15	29.8	Δ	980	89.7	89.8	88.7	0.81	146.90	2.00	2.6	6.40	183
FMC2-200LA-6	18.5	36.5	Δ	980	90.4	90.4	89.5	0.81	180.3	2.3	2.5	7.0	220.0
FMC2-200LB-6	22	42.6	Δ	980	90.9	90.9	89.9	0.82	214.4	2.3	2.8	7.0	240.0
FMC2-225M-6	30	58.3	Δ	985	91.7	91.8	90.6	0.81	292.3	2.2	2.3	6.5	275
FMC2-250M-6	37	69.0	Δ	985	92.2	92.3	91.1	0.84	360.6	2.5	2.3	6.9	385
FMC2-280S-6	45	81.5	Δ	985	92.7	92.7	91.5	0.86	438.5	2.2	2.3	7.0	482
FMC2-280M-6	55	99.2	Δ	985	93.1	93.2	92.0	0.86	536.0	2.4	2.3	7.1	559
FMC2-315S-6	75	134.3	Δ	985	93.7	94	92.5	0.86	727.2	2.8	2.3	7.3	933
FMC2-315M-6	90	160.7	Δ	985	94.0	93.9	92.6	0.86	872.6	2.7	2.2	7.1	1013
FMC2-315LA-6	110	195.8	Δ	985	94.3	94.3	92.9	0.86	1066.0	2.90	2.6	7.40	1086
FMC2-315LB-6	132	234.2	Δ	985	94.6	94.7	93.1	0.86	1280.0	3.1	2.4	7.6	1208.0
FMC2-355MA-6	160	280.0	Δ	990	94.8	94.9	93.4	0.87	1543.0	3.1	2.2	7.6	1581.0
FMC2-355MB-6	200	349.3	Δ	990	95.0	95.1	93.8	0.87	1929.0	3.0	2.2	7.8	1632
FMC2-355L-6	250	436.6	Δ	990	95.0	95.0	93.9	0.87	2412.0	3.0	2.2	7.7	1734

IE2 / 8 Pole

Motor Type	Power	Current(A) at 400V		Speed	Efficiency(η)			PF	Rated Torque			Locked Current	Weight
	(kw)	amp	Conn.	(rpm)	100%	75%	50%	($\cos\phi$)	(Nm)	Ts/Tn	Tmax/Tn	Is/In	(Kg)

Aluminium Motors

FMA2-100L1-8	0.75	2.44	Y	710	66.2	65.0	60.0	0.67	10.1	1.9	2.1	4.0	20
FMA2-100L2-8	1.10	3.3	Y	710	70.8	70.0	67.0	0.69	14.8	1.9	2.1	5.0	22
FMA2-112M-8	1.50	4.2	Δ	710	74.1	75	73.6	0.70	20.2	1.9	2.1	5.0	31
FMA2-132S-8	2.20	5.8	Δ	710	77.6	77.9	75.6	0.71	29.6	1.9	2.1	6.0	40
FMA2-132M-8	3.00	7.41	Δ	710	80.0	80.5	79.5	0.73	40.4	2.00	2.00	6.00	48
FMA2-160M1-8	4.00	9.66	Δ	720	81.9	82.4	81.2	0.73	53.1	2.0	2.1	6.0	67.0
FMA2-160M2-8	5.50	12.80	Δ	720	83.8	84.5	83.1	0.74	73.0	2.0	2.1	6.0	88.0
FMA2-160L-8	7.50	16.88	Δ	720	85.5	84.6	79.5	0.75	99.5	2.0	2.1	6.0	113

Cast Iron Motors

FMC2-180L-8	11	24.0	Δ	730	86.9	87.2	85.1	0.76	144.0	2.0	2.1	6.5	174
FMC2-200L-8	15	32.4	Δ	730	88.0	88.5	87.3	0.76	196.0	2.0	2.1	6.5	220
FMC2-225S-8	18.5	39.7	Δ	730	88.6	90	87.8	0.76	242.0	2.0	2.1	6.6	260
FMC2-225M-8	22	45.7	Δ	735	89.1	88.5	87.8	0.78	286.0	2.0	2.1	6.6	284
FMC2-250M-8	30	61.0	Δ	735	89.8	90.1	88.9	0.79	390.0	2.00	2.10	6.60	390
FMC2-280S-8	37	74.9	Δ	740	90.3	90.4	89.0	0.79	487.0	1.9	2.1	6.6	520.0
FMC2-280M-8	45	90.6	Δ	740	90.7	90.9	89.7	0.79	581.0	1.9	2.0	6.6	540.0
FMC2-315S-8	55	107.7	Δ	740	91.0	91.1	89.8	0.81	710.0	1.8	2.0	6.6	900
FMC2-315M-8	75	145.9	Δ	740	91.6	91.3	90.1	0.81	968.0	1.9	2.3	6.6	1000

FELCO®

IE2 / B3

Aluminium Motors

Frame Size	Pole	Mounting Dimensions (mm) IM-B3									Frame Dimensions(mm)			
		A	B	C	D	E	F	G	H	K	AB	AC	HD	L
56	2,4	90	71	36	9	20	3	7.2	56	5.8	110	113	156	195
63	2,4	100	80	40	11	23	4	8.5	63	7	122	121	167	218
63-34	2,4	100	80	40	11	23	4	8.5	63	7	122	121	167	251
71	2,4	112	90	45	14	30	5	11	71	7	138	140	186	250
80	2,4,6	125	100	50	19	40	6	15.5	80	10	160	159	206	294
90S	2,4,6	140	100	56	24	50	8	20	90	10	177	175	222	337
90L	2,4,6,8	140	125	56	24	50	8	20	90	10	177	175	222	363
100L	2,4,6,8	160	140	63	28	60	8	24	100	12	205	198	247	401
112M	2	190	140	70	28	60	8	24	112	12	222	218	281	405
112M-4	4,6,8	190	140	70	28	60	8	24	112	12	222	218	281	429
132S	2,4,6,8	216	140	89	38	80	10	33	132	12	256	258	320	467
132M	2,4,6,8	216	178	89	38	80	10	33	132	12	256	258	320	529
160M	2,4,6	254	210	108	42	110	12	37	160	15	302	314	406	617
160L	2,4,6	254	254	108	42	110	12	37	160	15	302	314	406	661

IM B3

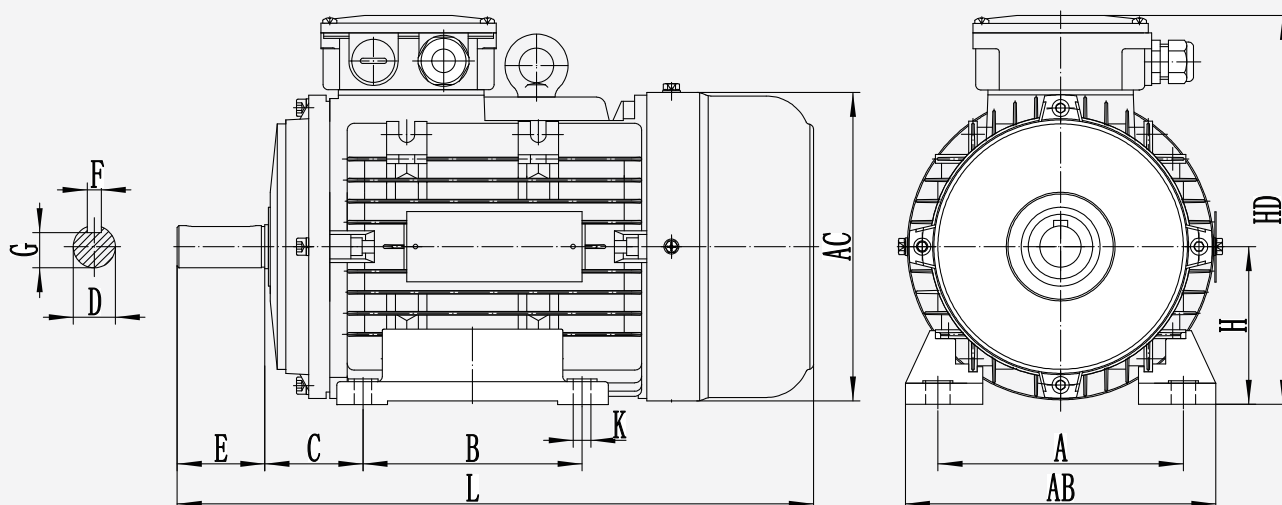

Cast Iron Motors

Frame Size	Pole	Mounting Dimensions (mm) IM-B3									Overall Dimensions (mm)			
		A	B	C	D	E	F	G	H	K	AB	AC	HD	L
180M	2,4,6,8	279	241	121	48	110	14	42.5	180	15	355	380	440	690
180L	2,4,6,8	279	279	121	48	110	14	42.5	180	15	355	380	440	725
200L	2,4,6,8	318	305	133	55	110	16	49	200	19	410	420	500	765
225S	4,6,8	356	286	149	60	140	18	53	225	19	445	470	555	810
225M	2	356	311	149	55	110	16	49	225	19	445	470	550	805
225M	4,6,8	356	311	149	60	140	18	53	225	19	445	470	550	835
250M	2	406	349	168	60	140	18	53	250	24	484	510	615	910
250M	4,6,8	406	349	168	65	140	18	58	250	24	484	510	615	910
280S	2	457	368	190	65	140	18	58	280	24	550	580	660	980
280S	4,6,8	457	368	190	75	140	20	67.5	280	24	550	580	660	980
280M	2	457	419	190	65	140	18	58	280	24	550	580	660	1030
280M	4,6,8	457	419	190	75	140	22	67.5	280	24	550	580	660	1030
315S	2	508	406	216	65	140	18	58	315	28	630	645	825	1180
315S	4,6,8	508	406	216	80	170	22	71	315	28	630	645	825	1275
315M	2	508	457	216	65	140	18	58	315	28	630	645	830	1290
315M	4,6,8	508	457	216	80	170	22	71	315	28	630	645	830	1320
315L	2	508	508	216	65	140	18	58	315	28	630	645	830	1290
315L	4,6,8	508	508	216	80	170	22	71	315	28	630	645	830	1320
355M	2	610	560	254	75	140	20	68	355	28	705	710	1010	1510
355M	4,6,8	610	560	254	95	170	25	86	355	28	705	710	1010	1540
355L	2	610	630	254	75	140	20	68	355	28	705	710	1010	1510
355L	4,6,8	610	630	254	95	170	25	86	355	28	705	710	1010	1540

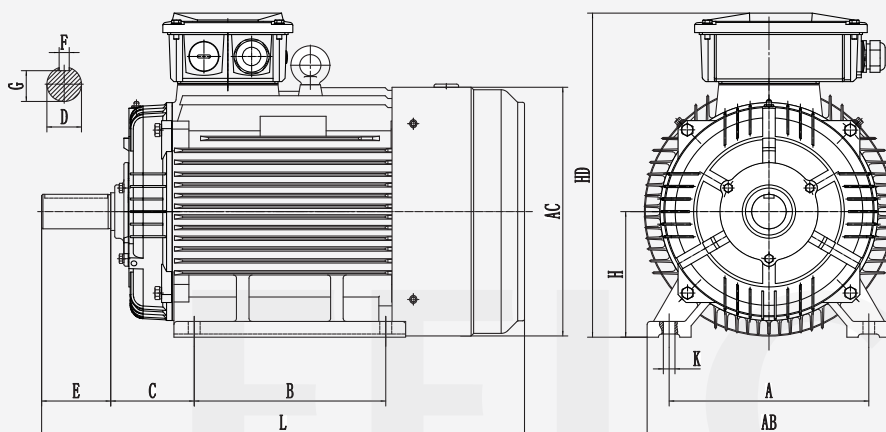

IE2 / B14

Aluminium Motors

Frame Size	Pole	Mounting Dimensions (mm) IM-B14									Frame Dimensions (mm)		
		M	N	P	D	R	F	G	S	T	AC	AD	L
56	2,4	65	50	80	9	0	3	7.2	M5	2.5	113	100	195
63	2,4	75	60	90	11	0	4	8.5	M5	2.5	121	104	218
71	2,4	85	70	105	14	0	5	11	M5	2.5	140	115	250
80	2,4	100	80	105	19	0	6	15.5	M6	3	159	126	294
90S	2,4,6	115	95	140	24	0	8	20	M8	3	175	132	337
90L	2,4,6	115	95	140	24	0	8	20	M8	3	175	132	363
100L	2,4,6,8	130	110	160	28	0	8	24	M8	3.5	198	147	401
112M	2	130	110	160	28	0	8	24	M8	3.5	218	169	405
112M-4	4,6,8	130	110	160	28	0	8	24	M8	3.5	218	169	429
132S	2,4,6,8	165	130	200	38	0	10	33	M10	3.5	258	188	467
132M	2,4,6,8	165	130	200	38	0	10	33	M10	3.5	258	188	505
160M	2,4,6	215	180	250	42	0	12	37	M12	4	314	246	617
160L	2,4,6	215	180	250	42	0	12	37	M12	4	314	246	661

IM B14

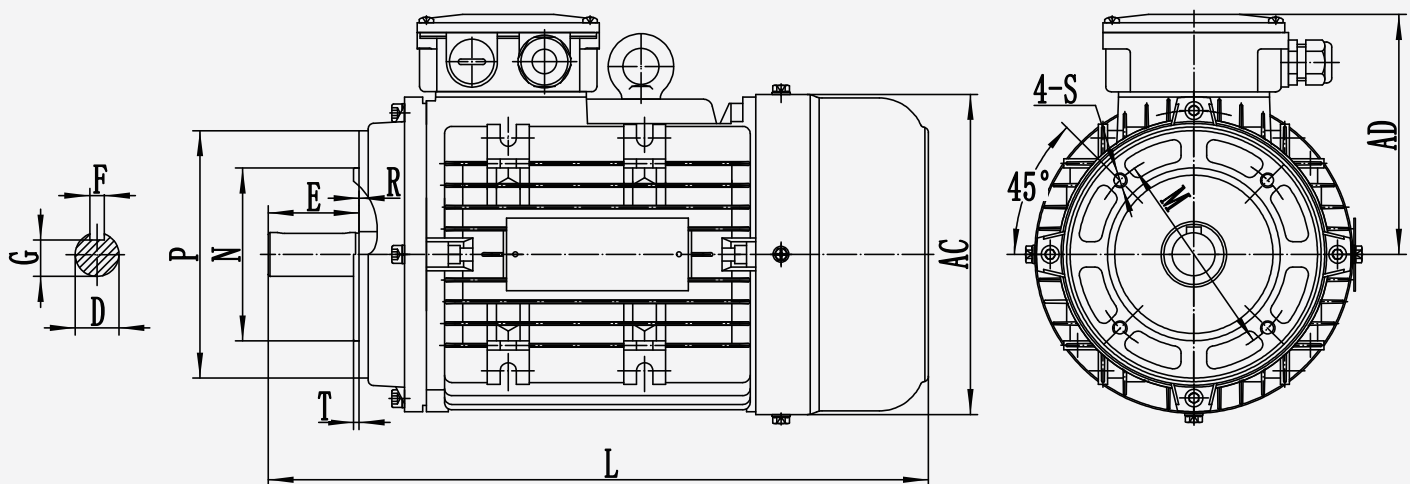

FELCO®

Aluminium Motors

Frame Size	Pole	Mounting Dimensions (mm) IM-B5									Frame Dimensions (mm)		
		M	N	P	D	R	F	G	S	T	AC	AD	L
56	2,4	100	80	120	9	0	3	7.2	7	3	113	100	195
63	2,4	115	95	140	11	0	4	8.5	10	3	121	104	213
71	2,4	130	110	160	14	0	5	11	10	3.5	140	115	250
80	2,4	165	130	200	19	0	6	15.5	10	3.5	159	126	294
90S	2,4,6	165	130	200	24	0	8	20	12	3.5	175	135	337
90L	2,4,6	165	130	200	24	0	8	20	12	3.5	175	135	363
100L	2,4,6,8	215	180	250	28	0	8	24	14.5	4	198	147	401
112M	2,4,6,8	215	180	250	28	0	8	24	14.5	4	218	169	405
112M-4	2,4,6,8	215	180	250	28	0	8	24	14.5	4	218	169	429
132S	2,4,6,8	265	230	300	38	0	10	33	14.5	4	258	188	467
132M	2,4,6,8	265	230	300	38	0	10	33	14.5	4	258	188	505
160M	2,4,6	300	250	350	42	0	12	37	18.5	5	314	246	617
160L	2,4,6	300	250	350	42	0	12	37	18.5	5	314	246	661

IM B5

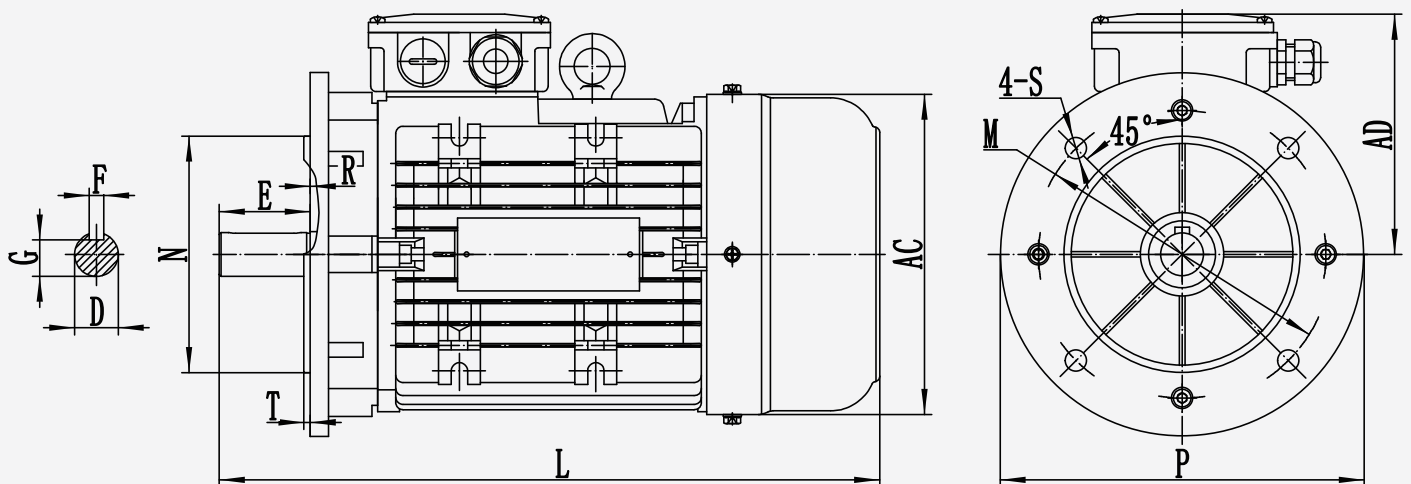

IE2 / B5

Cast Iron Motors

Frame Size	Pole	Mounting Dimensions (mm) IM-B5											Overall Dimensions(mm)		
		M	N	P	D	E	F	G	H	R	S	T	AC	AD	L
180M	2,4,6,8	300	250	350	48	110	14	42.5	180	0	4-19	5	380	280	690
180L	2,4,6,8	300	250	350	48	110	14	42.5	180	0	4-19	5	380	280	725
200L	2,4,6,8	350	300	400	55	110	16	49	200	0	4-19	5	420	305	765
225S	4,6,8	400	350	450	60	140	18	53	225	0	8-19	5	470	335	810
225M	2	400	350	450	55	110	16	49	225	0	8-19	5	470	335	805
225M	4,6,8	400	350	450	60	140	18	53	225	0	8-19	5	470	335	835
250M	2	500	450	550	60	140	18	53	250	0	8-19	5	510	370	910
250M	4,6,8	500	450	550	65	140	18	58	250	0	8-19	5	510	370	910
280S	2	500	450	550	65	140	18	58	280	0	8-19	5	580	410	980
280S	4,6,8	500	450	550	75	140	20	67.5	280	0	8-19	5	580	410	980
280M	2	500	450	550	65	140	18	58	280	0	8-19	5	580	410	1030
280M	4,6,8	500	450	550	75	140	20	67.5	280	0	8-19	5	580	410	1030
315S	2	600	550	660	65	140	18	58	315	0	8-24	6	645	630	1180
315S	4,6,8	600	550	660	80	170	22	71	315	0	8-24	6	645	630	1275
315M	2	600	550	660	65	140	18	58	315	0	8-24	6	645	630	1290
315M	4,6,8	600	550	660	80	170	22	71	315	0	8-24	6	645	630	1320
315L	2	600	550	660	65	140	18	58	315	0	8-24	6	645	630	1290
315L	4,6,8	600	550	660	80	170	22	71	315	0	8-24	6	645	630	1320
355M	2	740	680	800	75	140	20	68	355	0	8-24	6	701	710	1510
355M	4,6,8	740	680	800	95	170	25	86	355	0	8-24	6	710	710	1540
355L	2	740	680	800	75	140	20	68	355	0	8-24	6	710	710	1510
355L	2,4,6,8	740	680	800	95	170	25	86	355	0	8-24	6	710	710	1540

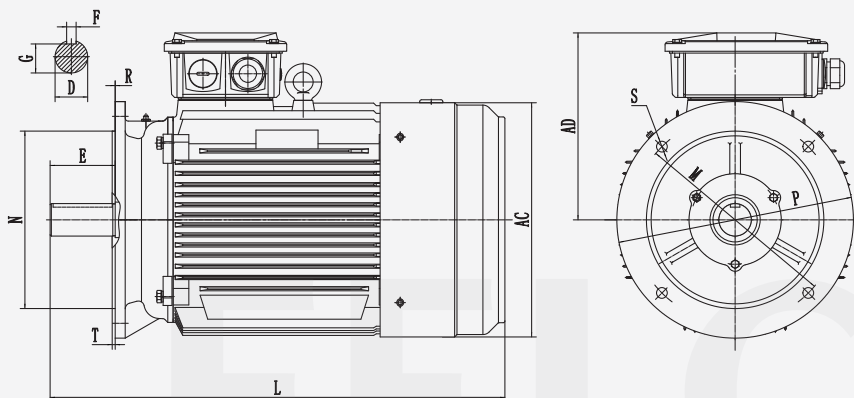

IE2 / B35

Cast Iron Motors

Frame Size	Pole	Mounting Dimensions (mm) IM- B35															Overall Dimensions(mm)			
		A	B	C	D	E	F	G	H	K	M	N	P	R	S	T	AB	AC	HD	L
180M	2,4,6,8	279	241	121	48	110	14	42.5	180	15	300	250	350	0	4-19	5	355	380	440	690
180L	2,4,6,8	279	279	121	48	110	14	42.5	180	15	300	250	350	0	4-19	5	355	380	440	725
200L	2,4,6,8	318	305	133	55	110	16	49	200	19	350	300	400	0	4-19	5	410	420	500	765
225S	4,6,8	356	286	149	60	140	18	53	225	19	400	350	450	0	8-19	5	445	470	555	810
225M	2	356	311	149	55	110	16	49	225	19	400	350	450	0	8-19	5	445	470	550	805
225M	4,6,8	356	311	149	60	140	18	53	225	19	400	350	450	0	8-19	5	445	470	550	835
250M	2	406	349	168	60	140	18	53	250	24	500	450	550	0	8-19	5	485	510	615	910
250M	4,6,8	406	349	168	65	140	18	58	250	24	500	450	550	0	8-19	5	485	510	615	910
280S	2	457	368	190	65	140	18	58	280	24	500	450	550	0	8-19	5	550	580	660	980
280S	4,6,8	457	368	190	75	140	20	67.5	280	24	500	450	550	0	8-19	5	550	580	660	980
280M	2	457	419	190	65	140	18	58	280	24	500	450	550	0	8-19	5	550	580	660	1030
280M	4,6,8	457	419	190	75	140	20	67.5	280	24	500	450	550	0	8-19	5	550	580	660	1030
315S	2	508	406	216	65	140	18	58	315	28	600	550	660	0	8-24	6	630	645	825	1180
315S	4,6,8	508	406	216	80	170	22	71	315	28	600	550	660	0	8-24	6	630	645	825	1275
315M	2	508	457	216	65	140	18	58	315	28	600	550	660	0	8-24	6	630	645	830	1290
315M	4,6,8	508	457	216	80	170	22	71	315	28	600	550	660	0	8-24	6	630	645	830	1320
315L	2	508	508	216	65	140	18	58	315	28	600	550	660	0	8-24	6	630	645	830	1290
315L	4,6,8	508	508	216	80	170	22	71	315	28	600	550	660	0	8-24	6	630	645	830	1320
355M	2	610	560	254	75	140	20	68	355	28	740	680	800	0	8-24	6	705	710	1010	1510
355M	4,6,8	610	560	254	95	170	25	86	355	28	740	680	800	0	8-24	6	705	710	1010	1540
355L	2	610	630	254	75	140	20	68	355	28	740	680	800	0	8-24	6	705	710	1010	1510
355L	4,6,8	610	630	254	95	170	25	86	355	28	740	680	800	0	8-24	6	705	710	1010	1540

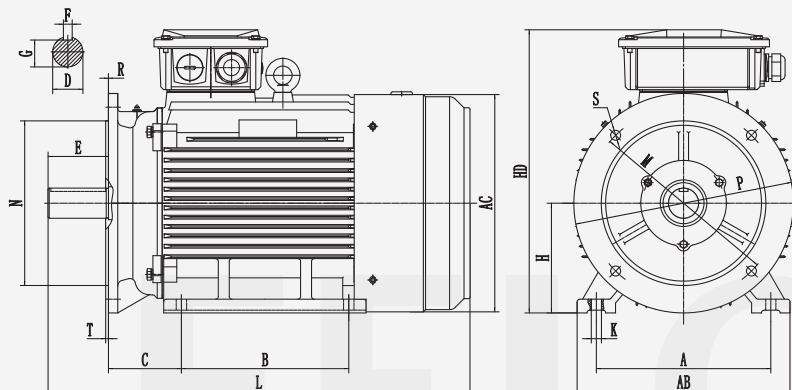

Bearing & Terminal Box

Bearing

Motor Type	Drive End		Non Drive End	
	2 Pole	4,6,8 Pole	2 Pole	4,6,8 Pole
FMA2-56	6201		6201	
FMA2-63	6201		6201	
FMA2-71	6202		6202	
FMA2-80	6204		6204	
FMA2-90	6205		6205	
FMA2-100	6206		6206	
FMA2-112	6306		6306	
FMA2-132	6308		6308	
FMA2-160	6309		6309	
FMC2-180	6311		6311	
FMC2-200	6312		6312	
FMC2-225	6312	6313	6312	
FMC2-250	6313	6314	6313	
FMC2-280	6314	6317	6314	
FMC2-315	6317	NU319	6317	6319
FMC2-355	6319	NU322	6319	6322

Terminal Box

Motor Type	Cable Gland	Blank cap	PTC Blank cap
FMA2-56	1*MG16*1.5	1*MG16*1.5	1*MG16*1.5
FMA2-63	1*MG16*1.5	1*MG16*1.5	1*MG16*1.5
FMA2-71	1*MG16*1.5	1*MG16*1.5	1*MG16*1.5
FMA2-80	1*MG20*1.5	1*MG20*1.5	1*MG16*1.5
FMA2-90	1*MG20*1.5	1*MG20*1.5	1*MG16*1.5
FMA2-100	1*MG20*1.5	1*MG20*1.5	1*MG16*1.5
FMA2-112	1*MG25*1.5	1*MG25*1.5	1*MG16*1.5
FMA2-132	1*MG25*1.5	1*MG25*1.5	1*MG16*1.5
FMA2-160	1*MG32*1.5	1*MG32*1.5	1*MG20*1.5
FMC2-180	1*MG32*1.5	1*MG32*1.5	1*MG20*1.5
FMC2-200	1*MG40*1.5	1*MG40*1.5	1*MG20*1.5
FMC2-225	1*MG40*1.5	1*MG40*1.5	1*MG20*1.5
FMC2-250	1*MG63*1.5	1*MG63*1.5	1*MG20*1.5
FMC2-280	1*MG63*1.5	1*MG63*1.5	1*MG20*1.5
FMC2-315	1*MG63*1.5	1*MG63*1.5	1*MG20*1.5
FMC2-355	1*MG72*1.5	1*MG72*2.0	1*MG20*1.5

Mounting Positions

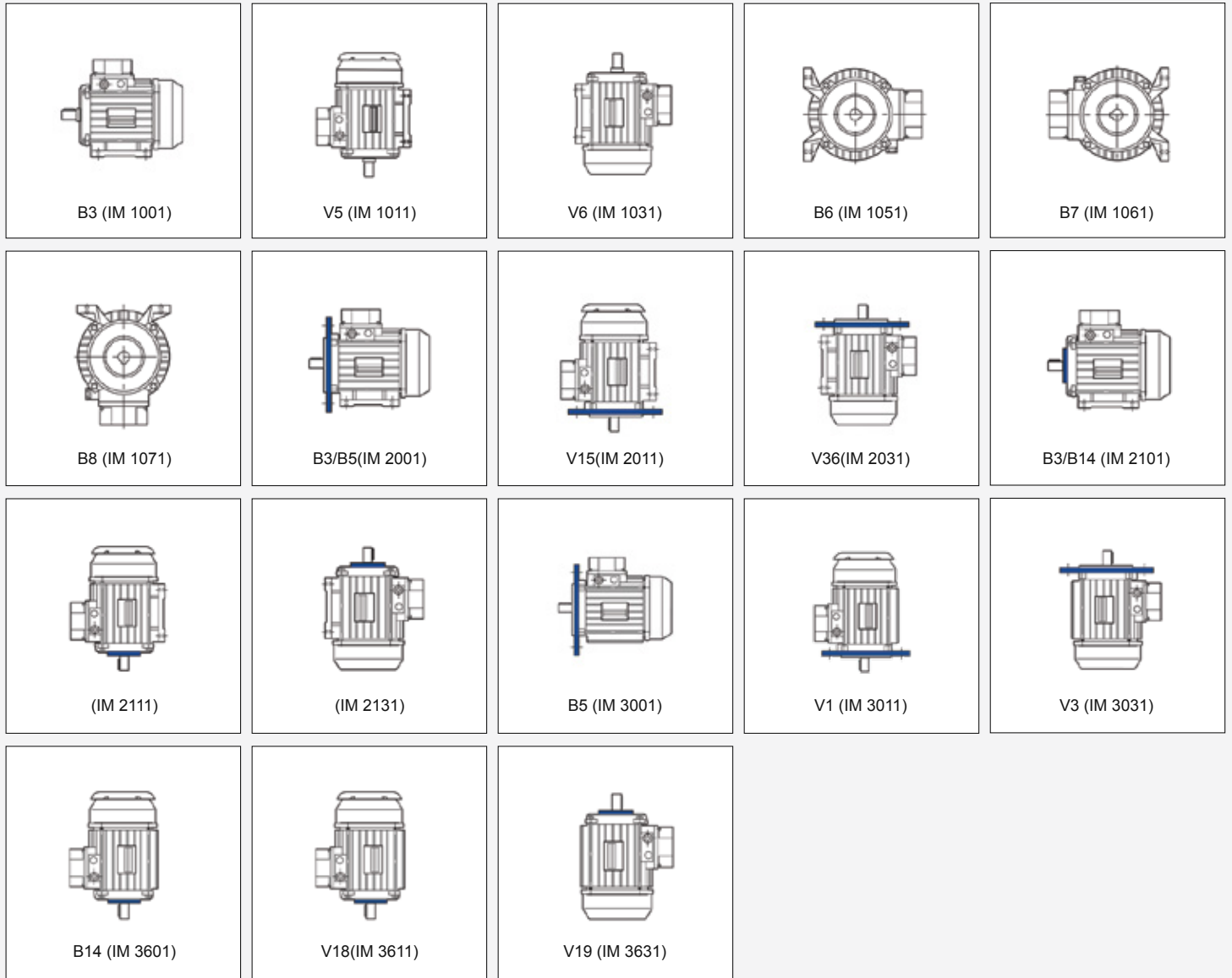

Rating Plate

		FELCO MOTORS BV Rotterdam-Netherlands www.felcomotors.nl		CE IE3											
TYPE	FMA3-132M-4	TEFC	IEC 60034-1	3~Mot	NR 625306450705101/2025										
V, Δ/λ	Hz	KW	Rpm	A, Δ/λ	Cos	Brgs	Eff. (100%)								
230/400	50	3	1450	10.47/6.02	0.82	DE 6206ZC3	87.87								
460	60	3.45	1750	6.02	0.82	NDE 6206ZC3	87.87								
Ins.Cl	F	Duty	S1	SF	1.0	IP	55	Kg	33	IM	B3	Amb.	50°C	PTC	150°C

Services & After Sales Support

At **FELCO**, our commitment to quality extends beyond the manufacturing process. We offer comprehensive service and after-sales support to ensure the long-term performance, reliability, and safety of our electric motors.

Our global service network and experienced technical teams provide assistance throughout the entire lifecycle of the motor—from installation and commissioning to maintenance and upgrades.

Our support includes

- Technical consultation and application engineering
- On-site commissioning and start-up support
- Preventive maintenance programs tailored to customer needs
- Spare parts availability and fast response for critical components
- Motor rewinding and refurbishment services
- Condition monitoring and diagnostics (vibration, temperature, insulation)
- Training programs for customer maintenance personnel

FELCO ensures that every motor installation is backed by dependable support, helping customers reduce downtime, optimize energy efficiency, and extend equipment lifespan.





FELCO MOTORS B.V

Tel : +31103072331

Email: info@felcomotors.nl

Website : www.felcomotors.com

Corporate Office:

Westplein 12, 3016BM

Rotterdam, Netherlands

WareHouse:

Jagersveld 6A, 5405 BW

Uden, Netherlands